

LEGEND



MUSTER STATION - DESIGNATED EMERGENCY ASSEMBLY AREA



CAFETERIA OR FOOD SERVICE

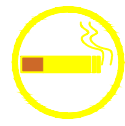

SMOKING AREA



EMERGENCY PHONE

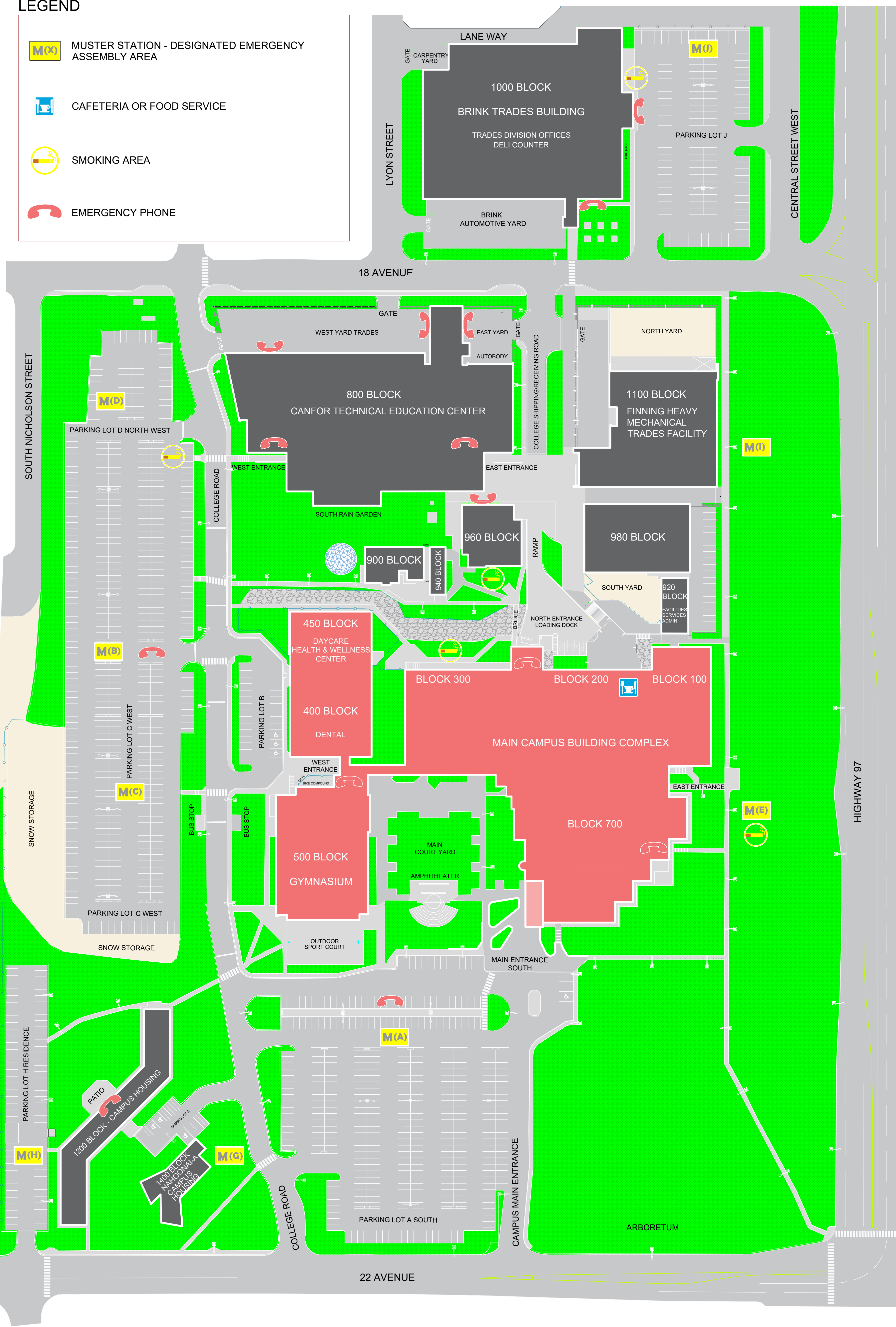
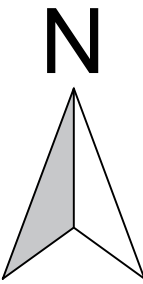

College of New Caledonia

Facility Services, Room 2-332, 3330 - 22nd Avenue, Prince George, British Columbia  
Tel (250) 561-5821, Fax (250) 561-5865, Web [www.cnc.bc.ca](http://www.cnc.bc.ca)

PROJECT: COLLEGE OF NEW CALEDONIA IN PRINCE GEORGE

DWG. TITLE: CAMPUS SITE PLAN - MAIN BUILDING

DR. BY:

ROOM NO.:

REVISION NO.:

REVISION TITLE:

NO.:

SCALE:

REVISION NO.:

REVISION TITLE:

DATE: DEC, 2023

SHEET: OF:

REVISION NO.:

REVISION TITLE:

LOCATION: PRINCE GEORGE, BRITISH COLUMBIA

SHEET NO.





For the latest construction updates, detours, and access info, visit and bookmark [cnc.bc.ca/construction](https://cnc.bc.ca/construction).

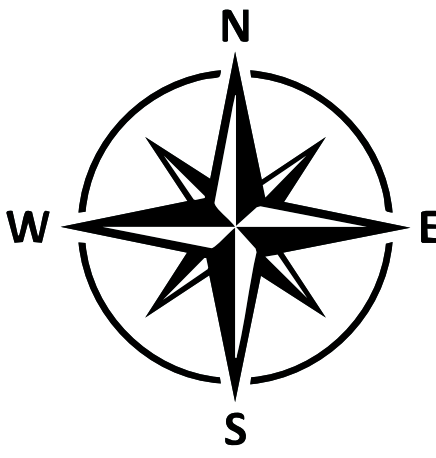

NORTH  
18 Ave

Cabling:  
August 12 - 16

More Cabling:  
July 28 - August 9

Cabling:  
July 21 - 25

Exit Legend

- Block# - Letter Exit
- ♿ Accessible
- ♿ Elevator
- ♿ Ramp

400 Block  
Dental

300 Block

200 Block

100 Block

Main Campus Building

West Entrance

East Entrance

LEVEL 1

500 Block  
Gymnasium

700 Block

Roof: July 21 - August 9

July 21 - August 9

MAIN SOUTH ENTRANCE  
MIGHT BE CLOSED  
July 21 - August 1

Main Entrance South

- 100 Block
- 200 Block
- 300 Block
- 400 Block
- 500 Block
- 700 Block

Construction Legend

- ⓧ Entrance/Exit Closed
- Red square Network Renewal Affected Areas
- Red arrow Building Envelope Affected Areas





For the latest construction updates, detours, and access info, visit and bookmark [cnc.bc.ca/construction](https://cnc.bc.ca/construction).

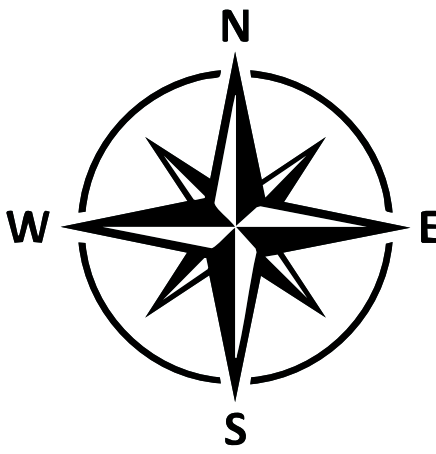

NORTH  
18 Ave

Cabling:  
August 12 - 16

More Cabling:  
July 28 - August 9

Cabling:  
July 21 - 25

Exit Legend

- Block# - Letter Exit
- ♿ Accessible
  - ♿ Elevator
  - ♿ Ramp

WEST  
College Road

EAST  
Hwy 97

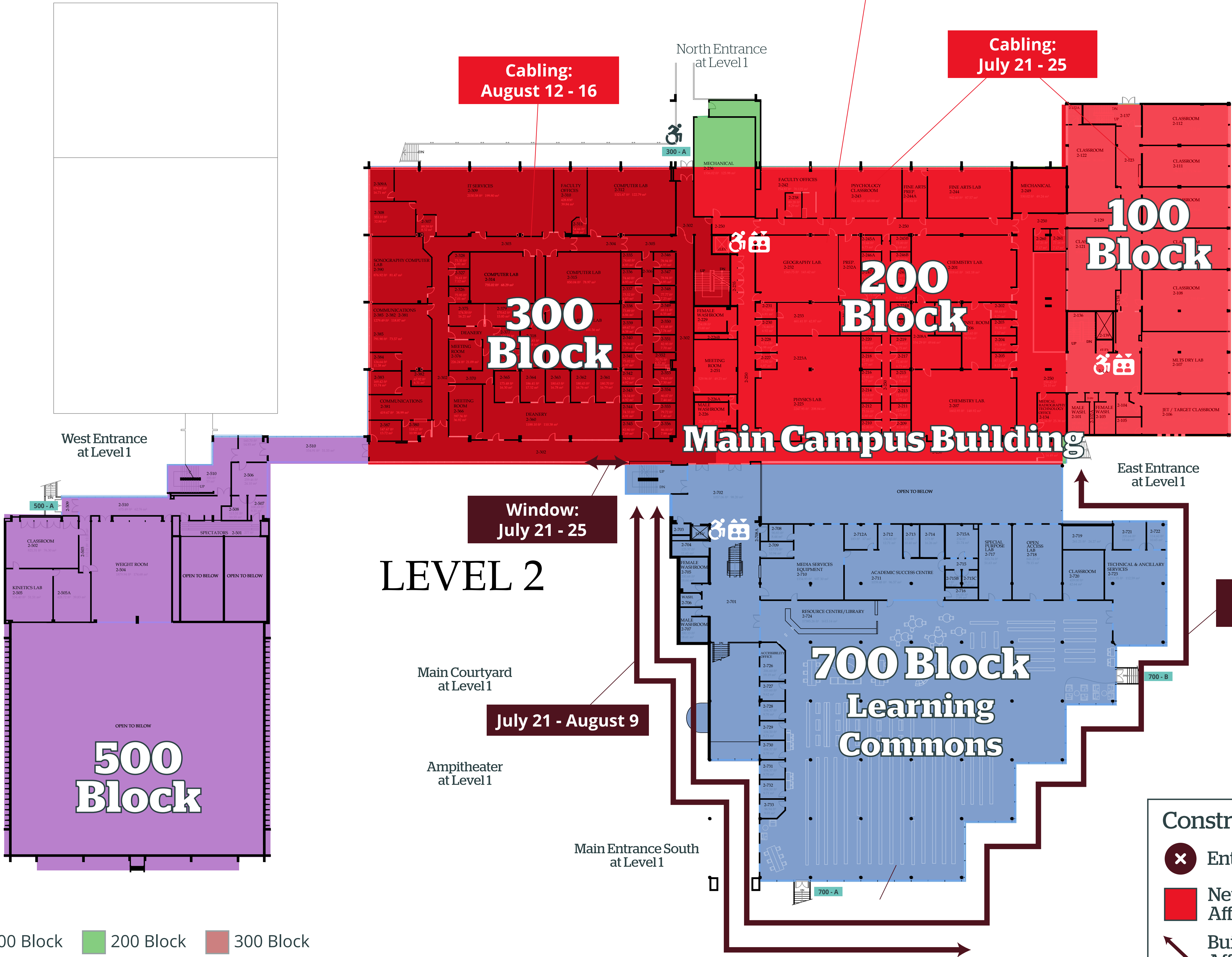

- 100 Block
- 200 Block
- 300 Block
- 400 Block
- 500 Block
- 700 Block

Construction Legend

- ⊗ Entrance/Exit Closed
- Red Box Network Renewal Affected Areas
- Red Arrow Building Envelope Affected Areas



For the latest construction updates, detours, and access info, visit and bookmark [cnc.bc.ca/construction](https://cnc.bc.ca/construction).

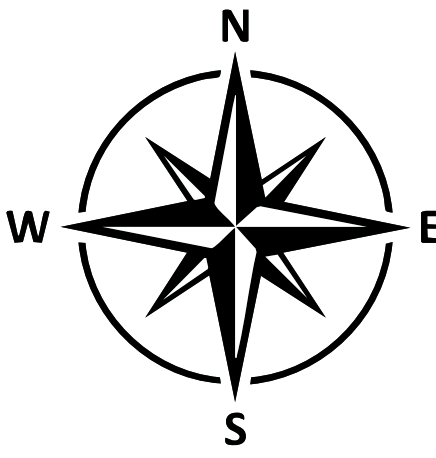

NORTH  
18 Ave

Cabling:  
August 12 - 16

More Cabling:  
July 28 - August 9

Cabling:  
July 21 - 25

Exit Legend

- Block# - Letter Exit
- ♿ Accessible
  - ♿ Elevator
  - ♿ Ramp

WEST  
College Road

West Entrance  
at Level 1

North Entrance  
at Level 1

East Entrance  
at Level 1

EAST  
Hwy 97

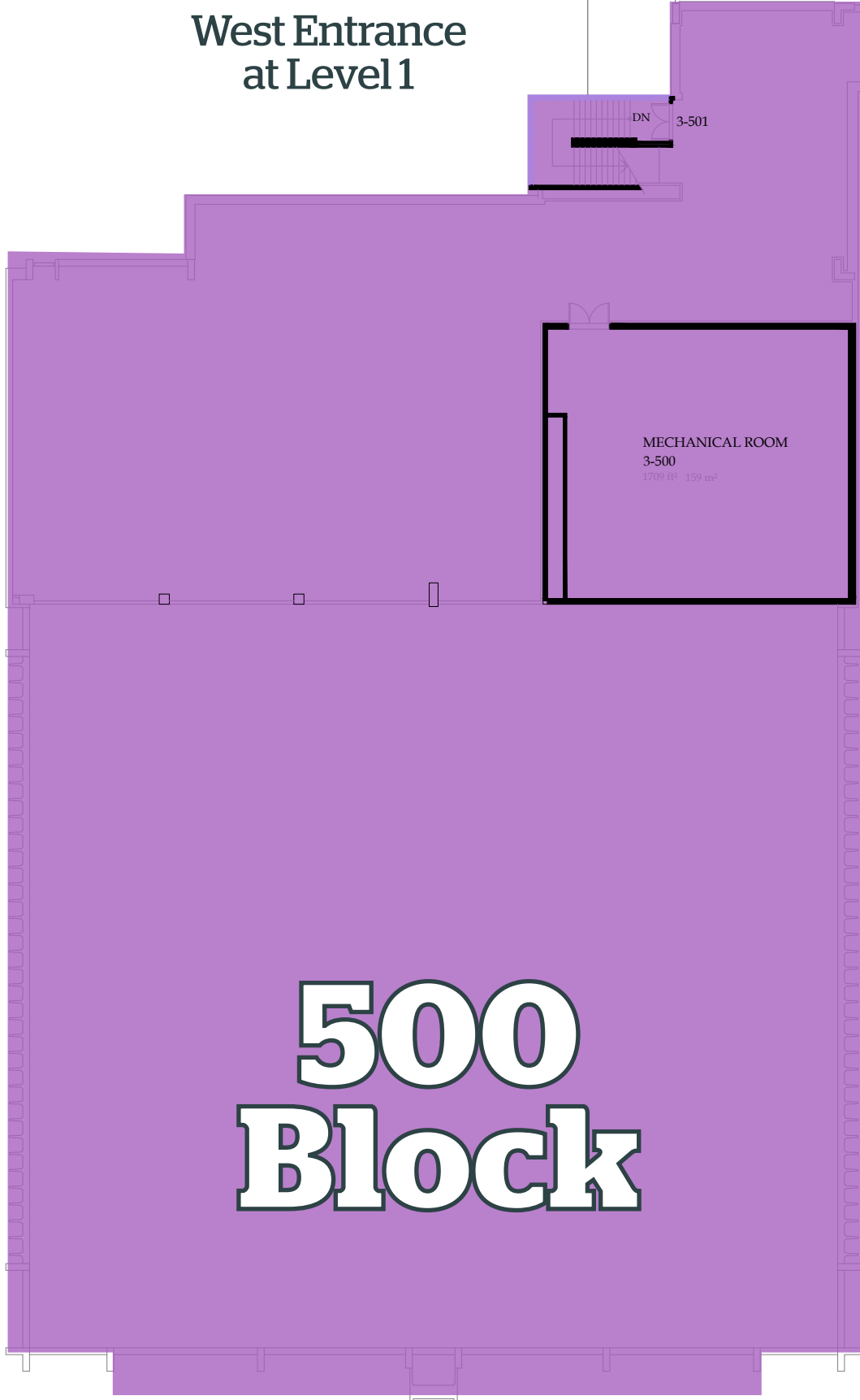

500  
Block

LEVEL 3

Main Courtyard  
at Level 1

Ampitheater  
at Level 1

Main Entrance South  
at Level 1

SOUTH  
22 Ave

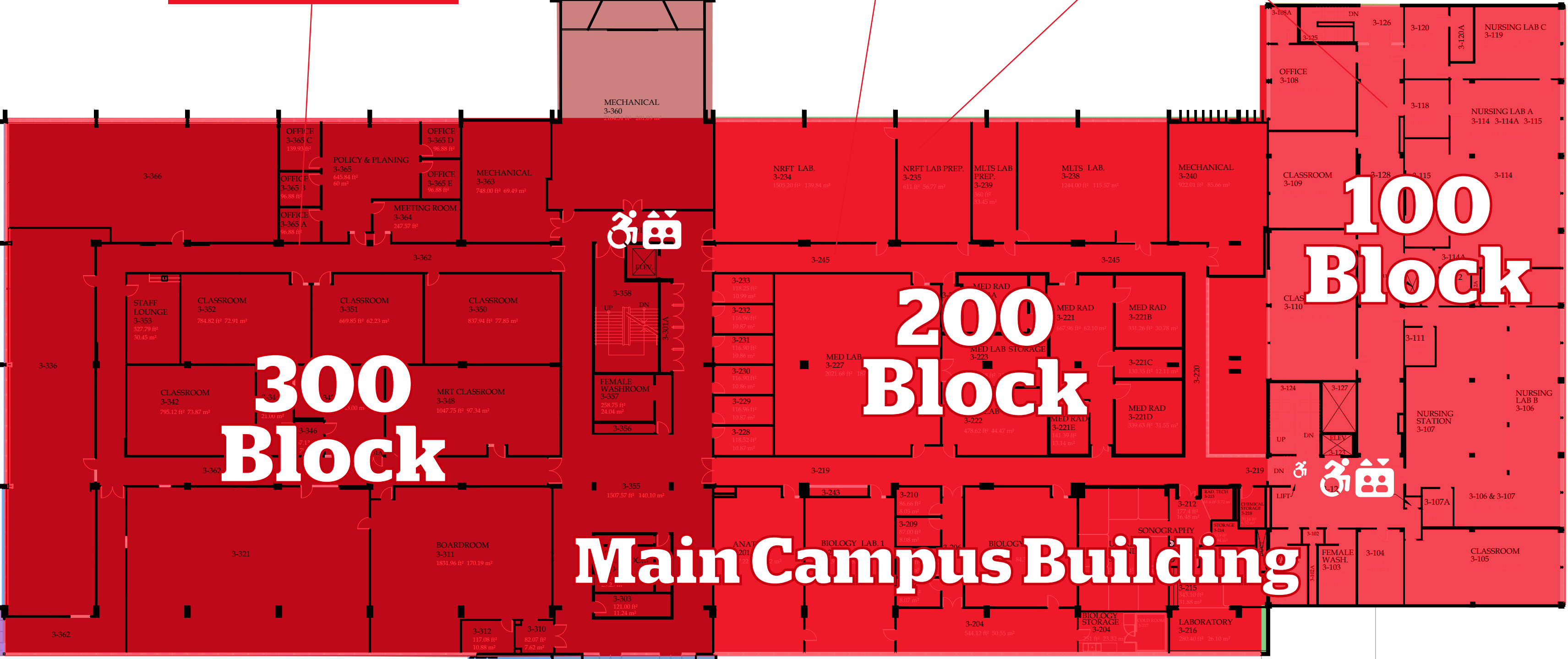

300  
Block

200  
Block

100  
Block

Main Campus Building

700  
Block

Roof: July 21 -  
August 9

- 100 Block
- 200 Block
- 300 Block
- 400 Block
- 500 Block
- 700 Block

Construction Legend

- ⊗ Entrance/Exit Closed
- Red square Network Renewal Affected Areas
- Red arrow Building Envelope Affected Areas