

**LEGEND**

	MUSTER STATION - DESIGNATED EMERGENCY ASSEMBLY AREA
	CAFETERIA OR FOOD SERVICE
	SMOKING AREA
	EMERGENCY PHONE

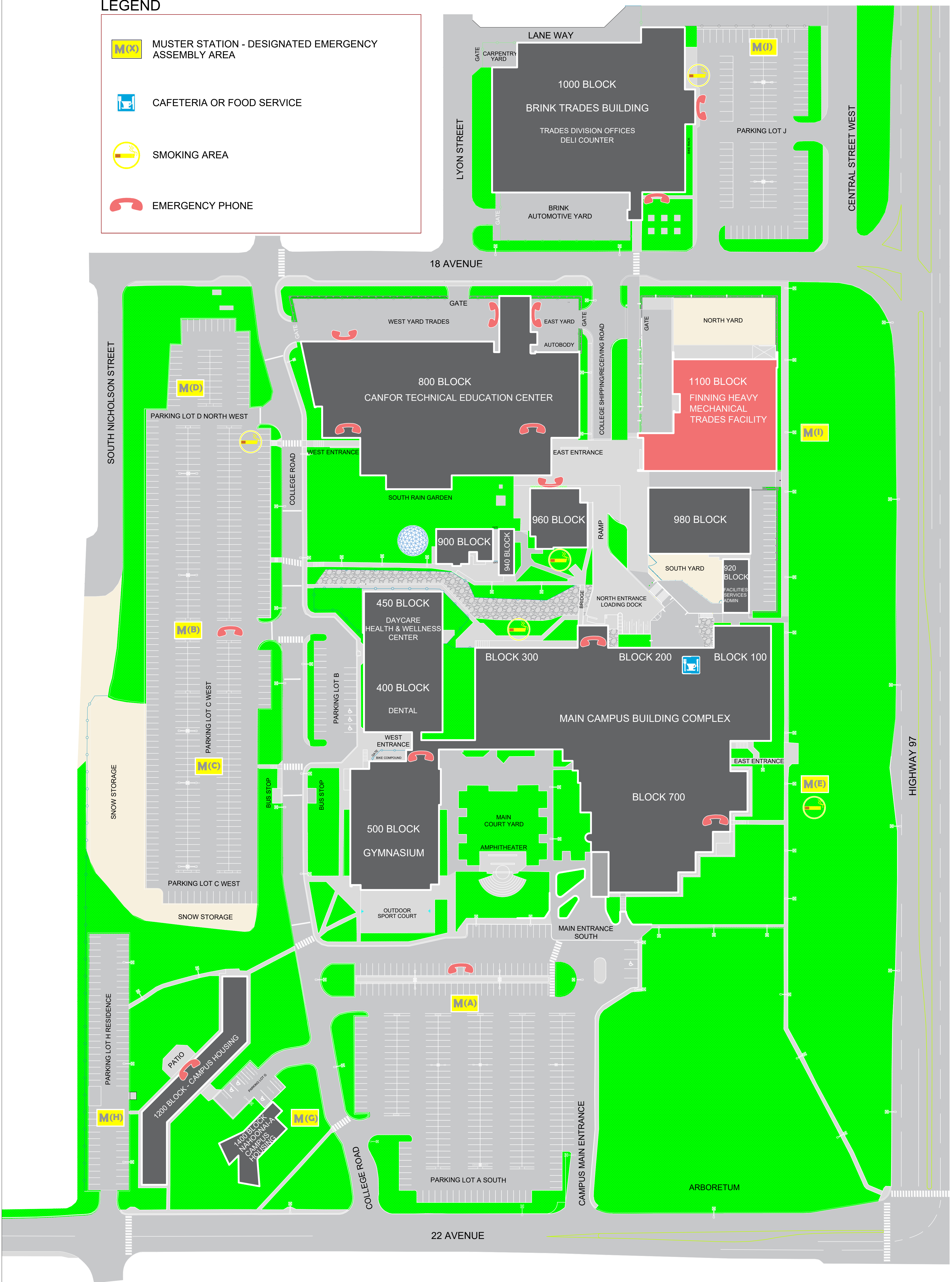

**College of New Caledonia**

Facility Services, Room 2-332, 3330 - 22nd Avenue, Prince George, British Columbia  
Tel (250) 561-5821, Fax (250) 561-5865, Web www.cnc.bc.ca

PROJECT: COLLEGE OF NEW CALEDONIA IN PRINCE GEORGE		SHEET NO.	
DWG. TITLE: CAMPUS SITE PLAN - 1100 BLOCK			
DR. BY:	ROOM NO.:	REVISION NO.:	REVISION TITLE:
NO.:	SCALE:	REVISION NO.:	REVISION TITLE:
DATE: DEC, 2023	SHEET: OF:	REVISION NO.:	REVISION TITLE:
LOCATION: PRINCE GEORGE, BRITISH COLUMBIA			



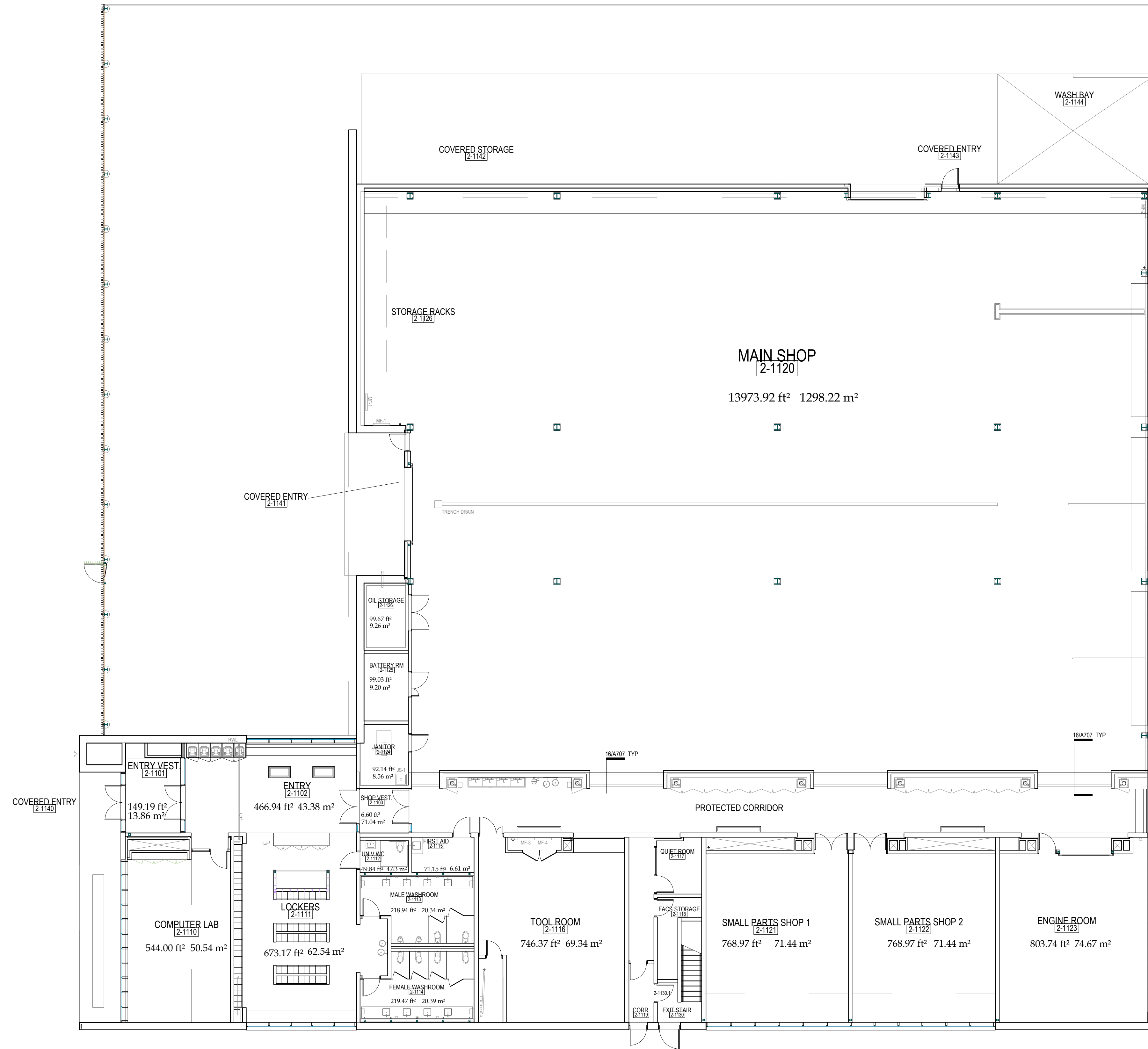

# LEVEL 1



## College of New Caledonia

Facility Services, Room 2-332, 3330 - 22nd Avenue, Prince George, British Columbia  
Tel (250) 561-5821, Fax (250) 561-5865, Web www.cnc.bc.ca

PROJECT: COLLEGE OF NEW CALEDONIA IN PRINCE GEORGE			
DWG. TITLE: 1100 BLOCK - HMTF - LEVEL 1			
DR. BY:	ROOM NO.:	REVISION NO.:	REVISION TITLE:
NO.:	SCALE: NTS	REVISION NO.:	REVISION TITLE:
DATE: DEC, 2023	SHEET: 1 OF: 2	REVISION NO.:	REVISION TITLE:
LOCATION: PRINCE GEORGE, BRITISH COLUMBIA			

Note:	

SHEET NO.	
-----------	--

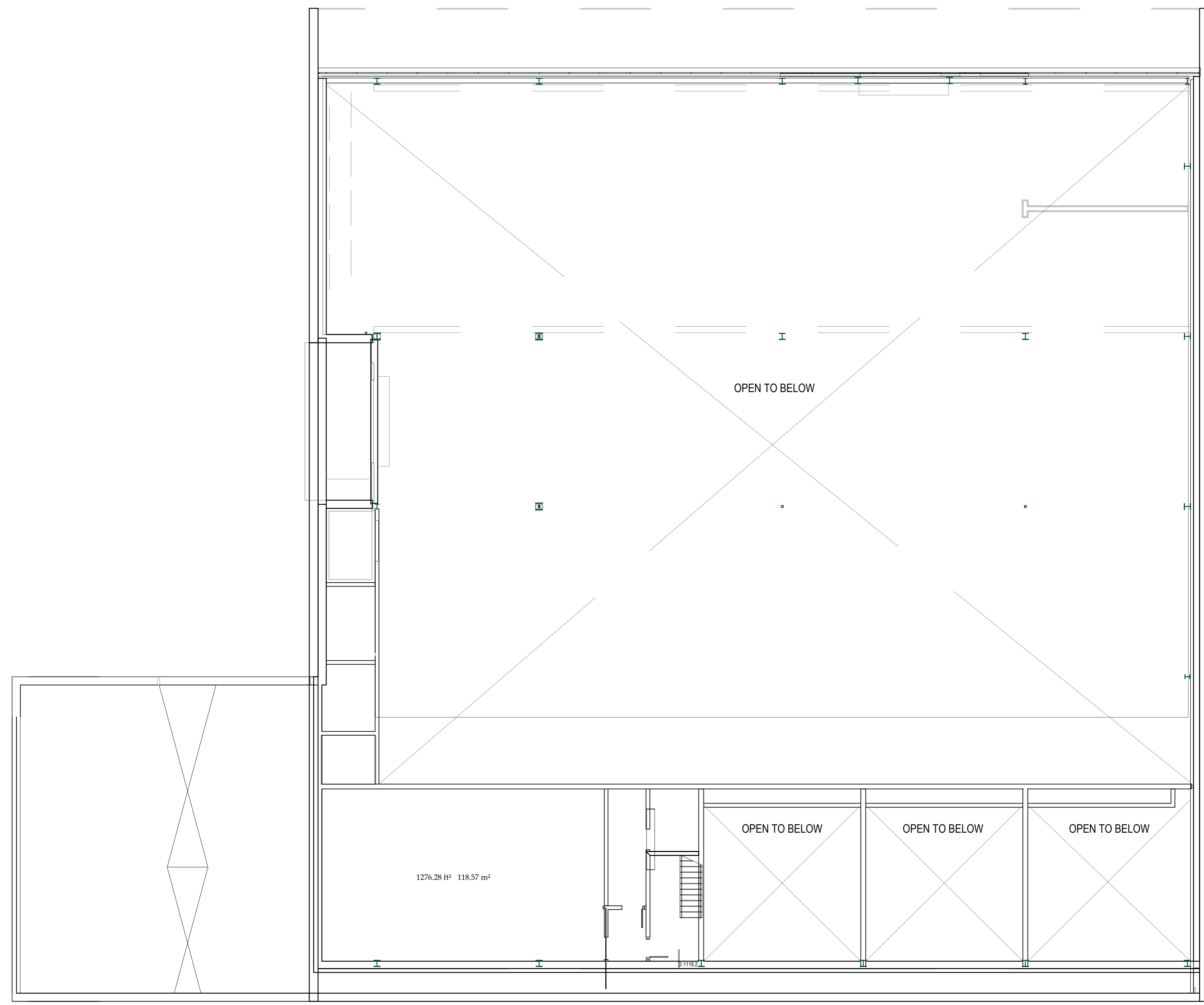
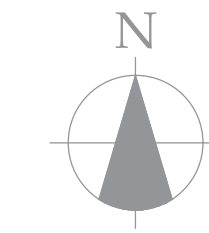

## LEVEL 2



# College of New Caledonia

Facility Services, Room 2-332, 3330 - 22nd Avenue, Prince George, British Columbia  
Tel (250) 561-5821, Fax (250) 561-5865, Web [www.cnc.bc.ca](http://www.cnc.bc.ca)

PROJECT:	COLLEGE OF NEW CALEDONIA IN PRINCE GEORGE		
DWG. TITLE:	1100 BLOCK - HMTF - LEVEL 2		
DR. BY:	ROOM NO:	REVISION NO:	REVISION TITLE:
NO.:	SCALE: NTS	REVISION NO:	REVISION TITLE:
DATE: DEC, 2023	SHEET: 2 OF: 2	REVISION NO:	REVISION TITLE:
LOCATION: PRINCE GEORGE, BRITISH COLUMBIA			

Note:	

SHEET NO.	
-----------	--